

Model

4AM-70C-CB20

(8 Vanes, Reversible)

Net wt. for standard configuration
60 lbs (27,0 kg)

FEATURES

- 20:1 gear reducer
- Base mounting
- Optional mountings and shaft locations available
- Metal muffler AC980 adds 2" height when installed

RECOMMENDED

- Filter AH103F
- Regulator AH104R
- Gauge AA806
- Lubricator AH105L
- Oil AD220 – 1 quart (.94 litres)
- Repair kit K280A (Air motor only)

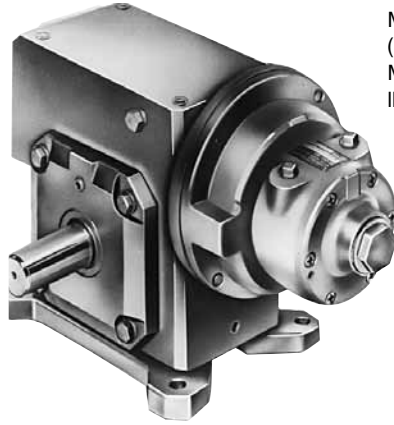

Max. allowable end thrust with 0 overhung load is 2259 lbs (1016,6 kg) at 30 rpm to 1335 lbs (600,8 kg) at 150 rpm.
Max. overhung load on output shaft with 0 end thrust 1601 lbs (720,4 kg).

Product Dimensions (inches, mm)

“B” Mounting (photo) 4AM-70C-CB20/4AM-70C-CF20 (standard shaft) (opposite shaft)

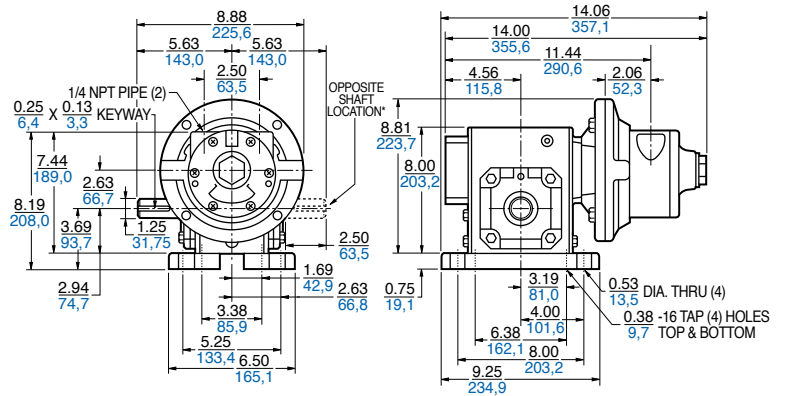

“C” Mounting 4AM-70C-CC20/4AM-70C-CG20 (standard shaft) (opposite shaft)

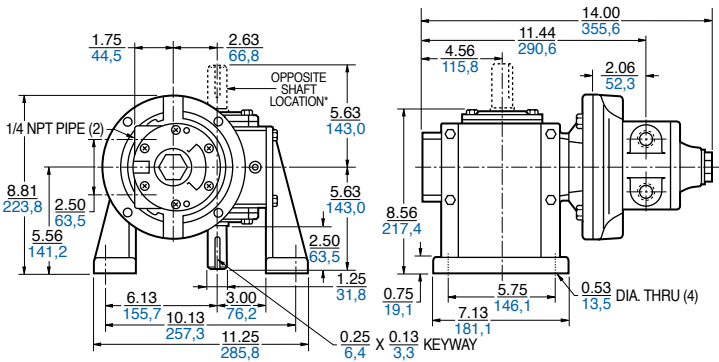

“D” Mounting 4AM-70C-CD20/4AM-70C-CH20 (standard shaft) (opposite shaft)

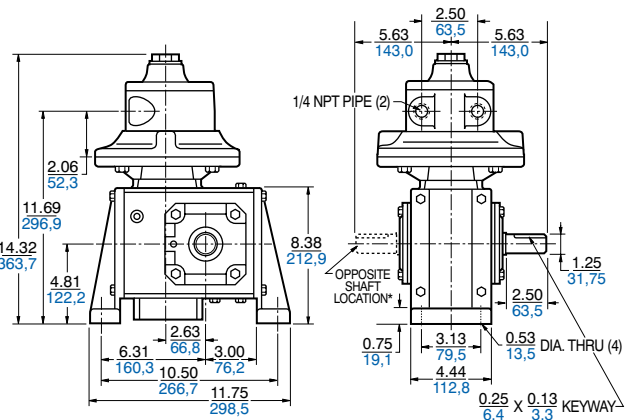

Output Power vs. Speed

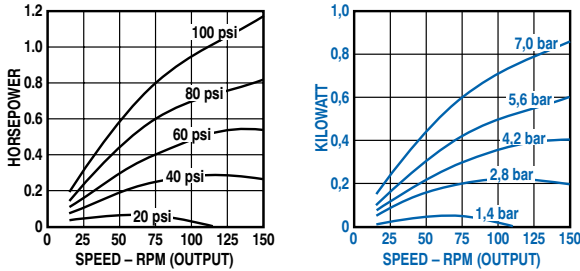

Air Consumption vs. Speed

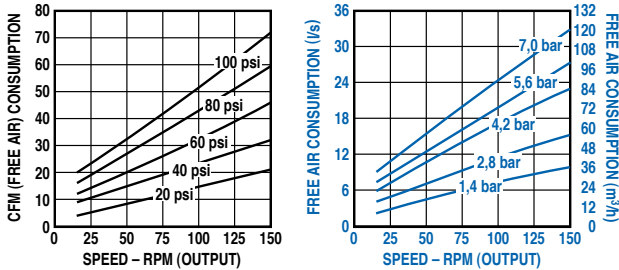

Torque vs. Speed

