

Side channel blowers three-phase

Type	Motor power kW	Voltage V	Maximum current A	Maximum duty m³/h	Sound level** dB(A)	Weight kg	Article number
SC10A-037T	0,37	230 Δ / 400 Y	1,76 Δ / 1,02 Y	110	70	15,0	113 750 120
SC10A-055T*	0,55	230 Δ / 400 Y	2,35 Δ / 1,35 Y	110	70	16,0	113 750 125
SC10C-055T	0,55	230 Δ / 400 Y	2,35 Δ / 1,35 Y	110	72	16,0	113 750 130
SC10C-075T	0,75	230 Δ / 400 Y	3,3 Δ / 1,9 Y	110	72	18,5	113 750 135
SC20A-110T*	1,10	230 Δ / 400 Y	4,3 Δ / 2,5 Y	190	75	22,0	113 750 185
SC20A-150T	1,50	230 Δ / 400 Y	5,9 Δ / 3,4 Y	190	77	24,5	113 750 190
SC20C-110T	1,10	230 Δ / 400 Y	4,5 Δ / 2,5 Y	190	75	22,0	113 750 200
SC20C-150T*	1,50	230 Δ / 400 Y	5,9 Δ / 3,4 Y	190	77	24,5	113 750 205
SC30A-220T*	2,20	230 Δ / 400 Y	8,0 Δ / 4,6 Y	320	78	36,0	113 750 270
SC30A-300T	3,00	230 Δ / 400 Y	11,3 Δ / 6,5 Y	320	80	40,0	113 750 272
SC30C-220T	2,20	230 Δ / 400 Y	8,0 Δ / 4,6 Y	320	78	36,0	113 750 275
SC30C-300T*	3,00	230 Δ / 400 Y	11,3 Δ / 6,5 Y	320	81	40,0	113 750 283
SC40A-400T	4,00	400 Δ / 690 Y	7,8 Δ	650	82	67,0	113 750 325
SC40A-550T*	5,50	400 Δ / 690 Y	10,6 Δ	650	84	70,0	113 750 330
SC40A-750T*	7,50	400 Δ / 690 Y	14,0 Δ	650	85	73,0	113 750 335
SC40C-550T*	5,50	400 Δ / 690 Y	10,6 Δ	650	84	70,0	113 750 350
SC40C-750T*	7,50	400 Δ / 690 Y	14,0 Δ	650	86	73,0	113 750 352
SC50A-750T	7,50	400 Δ / 690 Y	14,0 Δ	1100	82	126,0	113 750 400
SC50A-1100T*	11,00	400 Δ / 690 Y	21,2 Δ	1100	84	128,0	113 750 411
SC50A-1500T	15,00	400 Δ / 690 Y	27,2 Δ	1100	87	155,0	113 750 420
SC50C-750T	7,50	400 Δ / 690 Y	14,0 Δ	1100	84	126,0	113 750 450
SC50C-1100T*	11,00	400 Δ / 690 Y	21,2 Δ	1100	86	128,0	113 750 455
SC50C-1500T	15,00	400 Δ / 690 Y	28,0 Δ	1100	88	155,0	113 750 460

** - with silencer

Side channel blowers single-phase

SC10A-037S	0,37	230	2,9	110	70	18,0	113 750 150
SC10A-055S*	0,55	230	4,0	110	70	19,0	113 750 155
SC10C-055S	0,55	230	4,0	110	72	19,0	113 750 160
SC10C-075S	0,75	230	5,2	110	72	21,5	113 750 165
SC20A-110S*	1,10	230	7,9	190	75	25,0	113 750 225
SC20A-150S	1,50	230	8,7	190	77	26,0	113 750 230
SC20C-110S	1,10	230	7,9	190	75	25,0	113 750 235
SC20C-150S	1,50	230	8,7	190	77	26,0	113 750 240
SC30A-220S	2,20	230	14,0	320	78	39,0	113 750 290

* - in stock

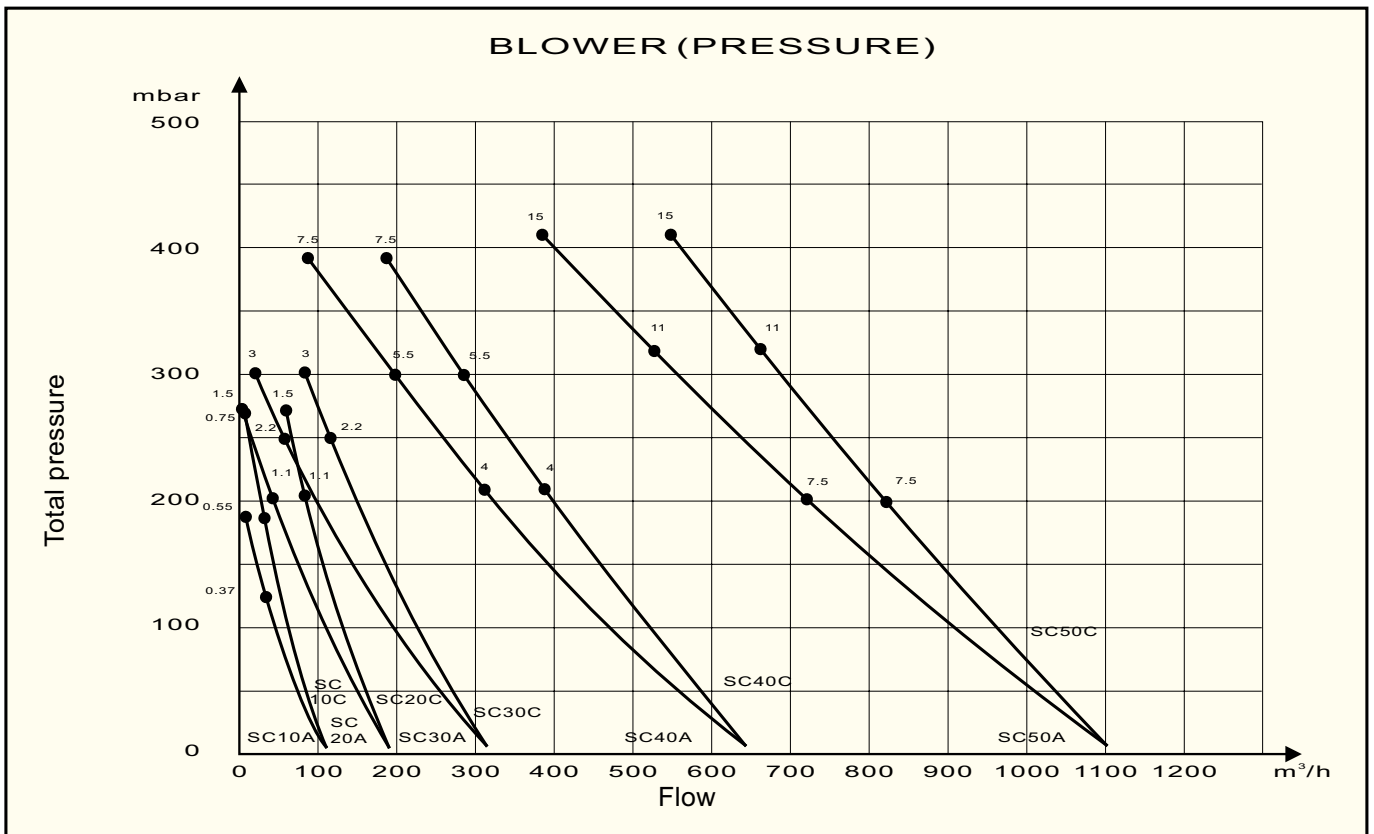
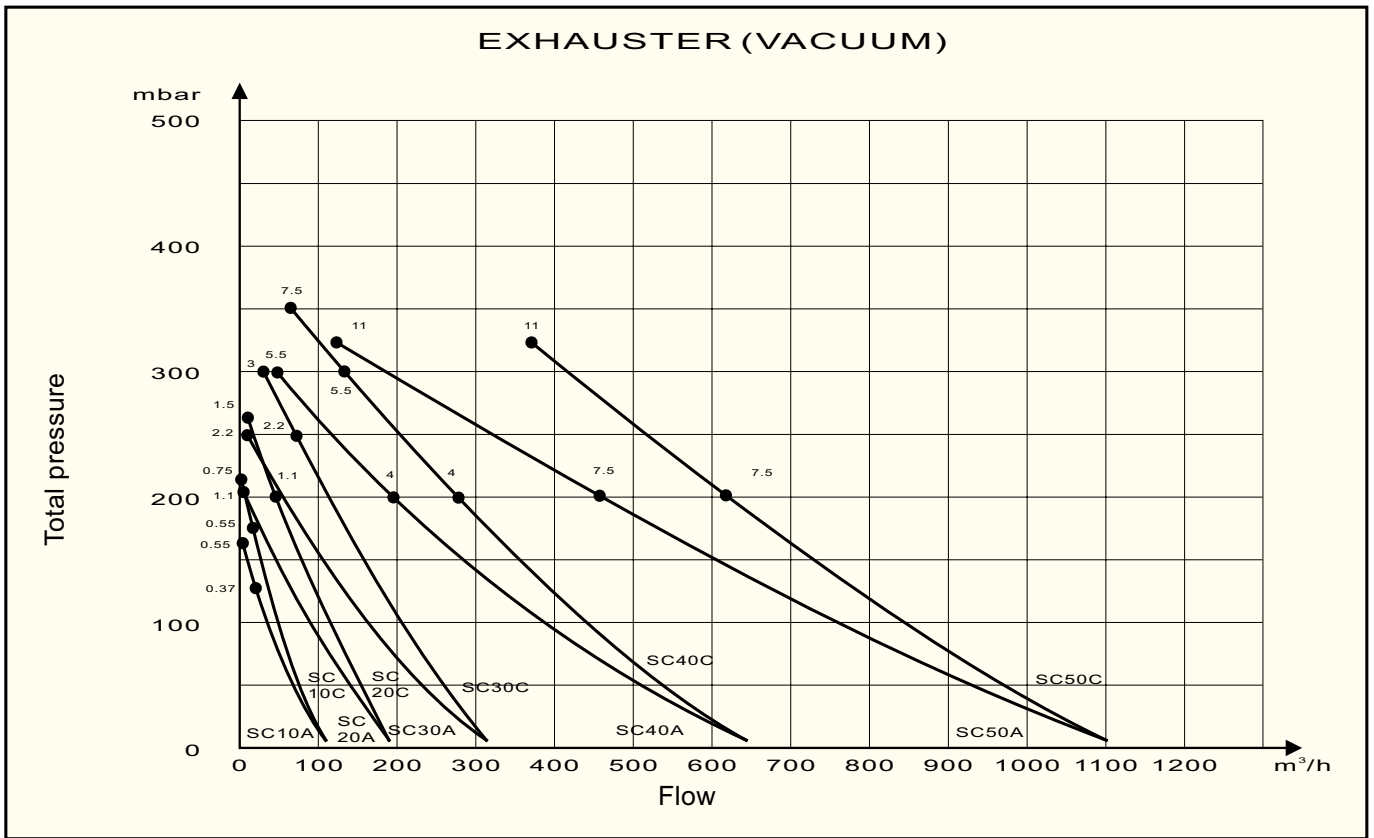

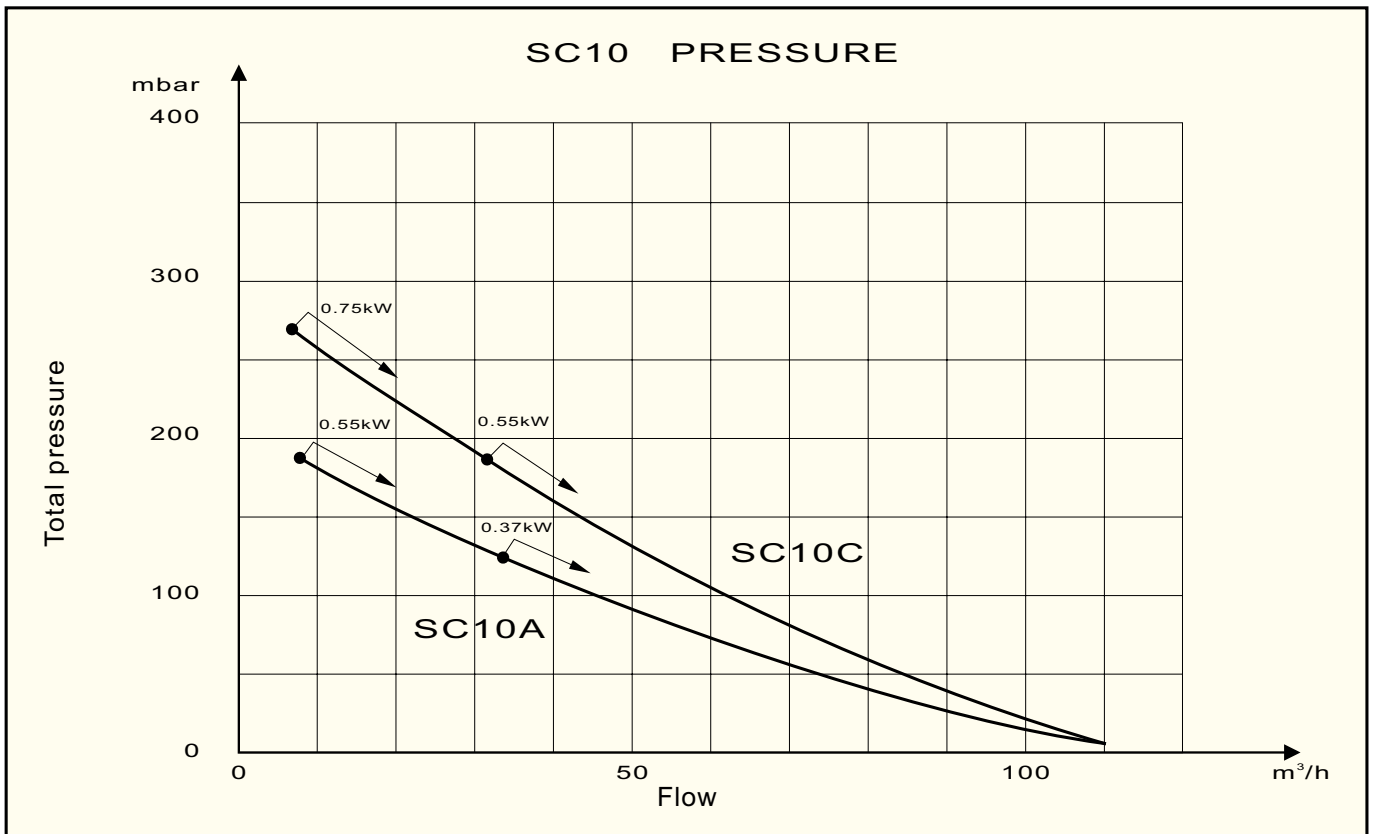
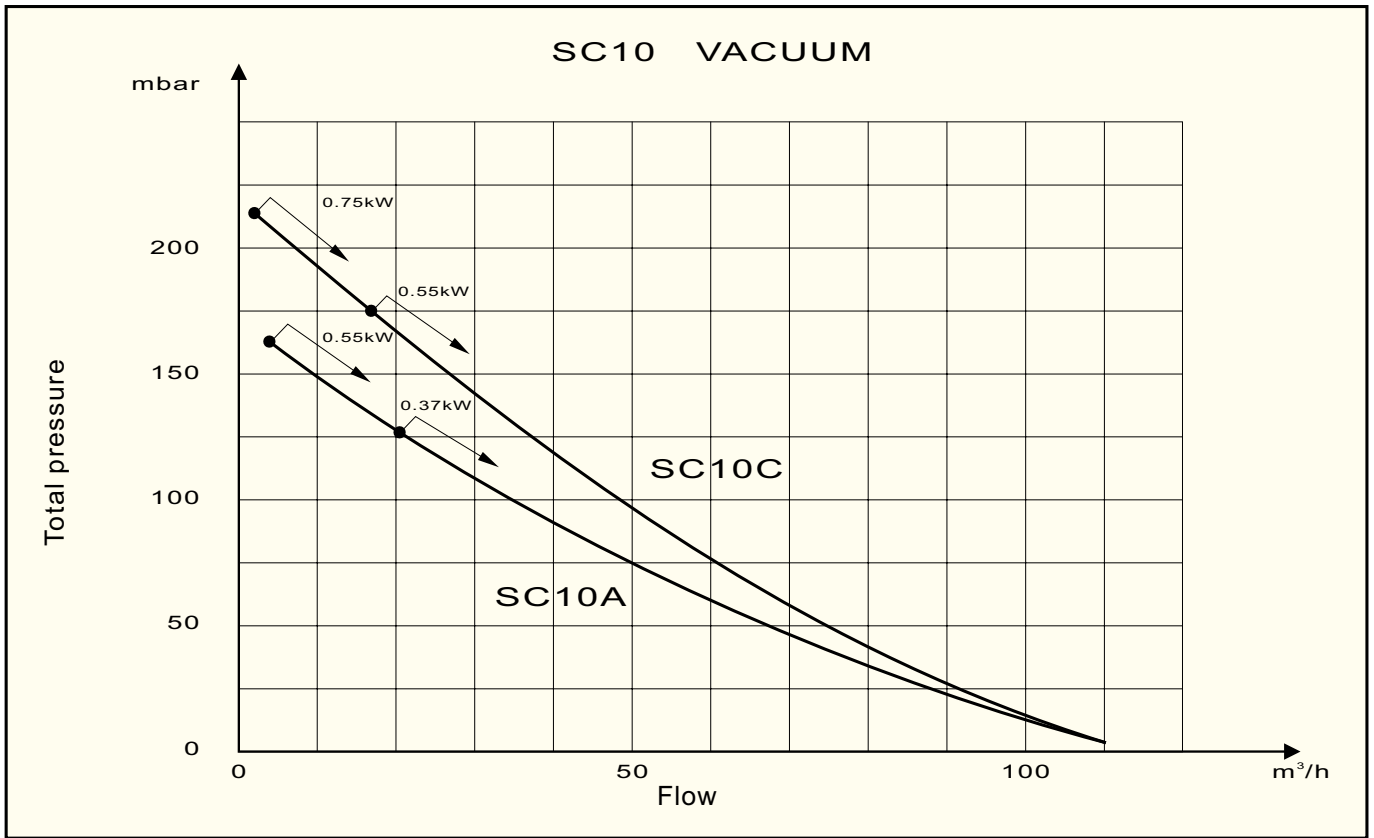

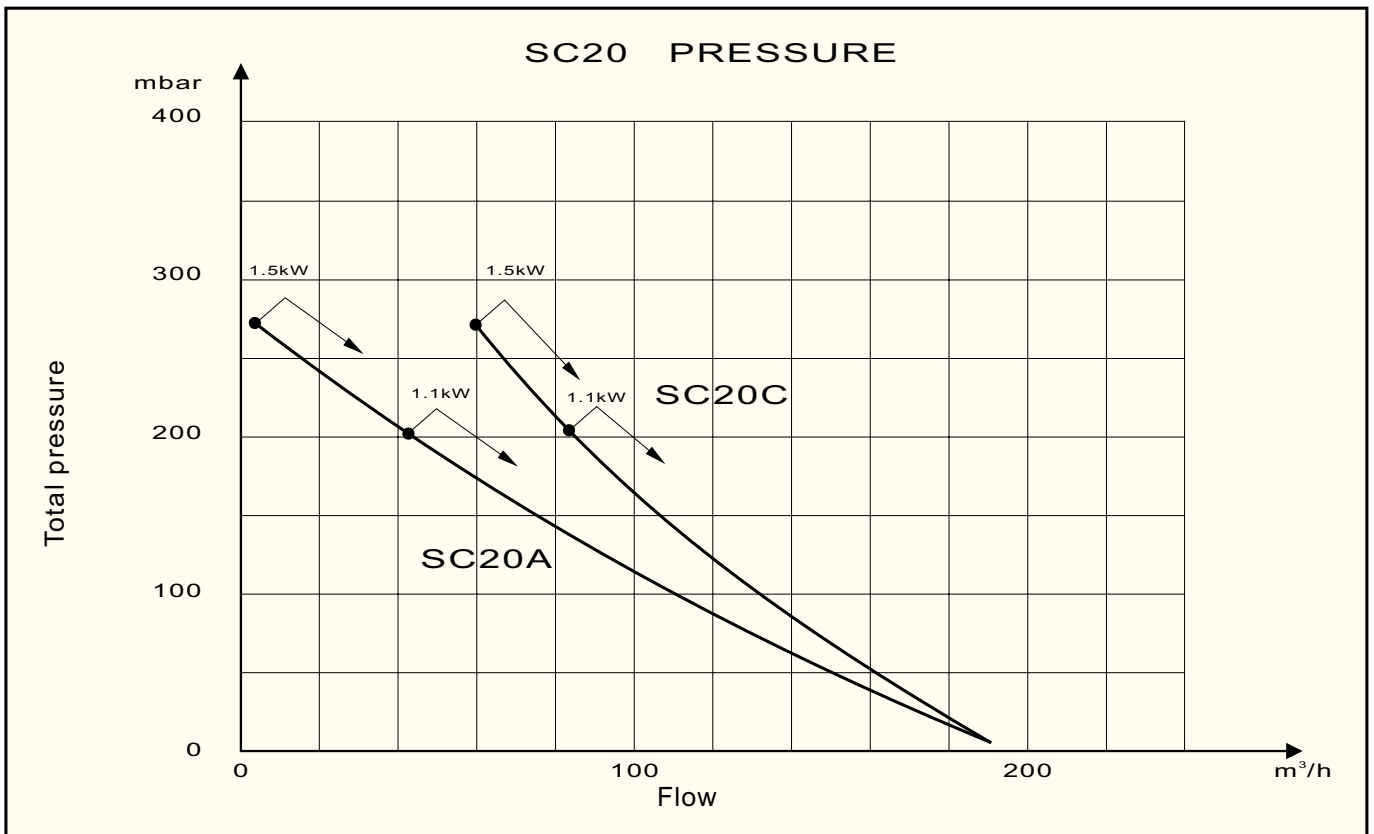
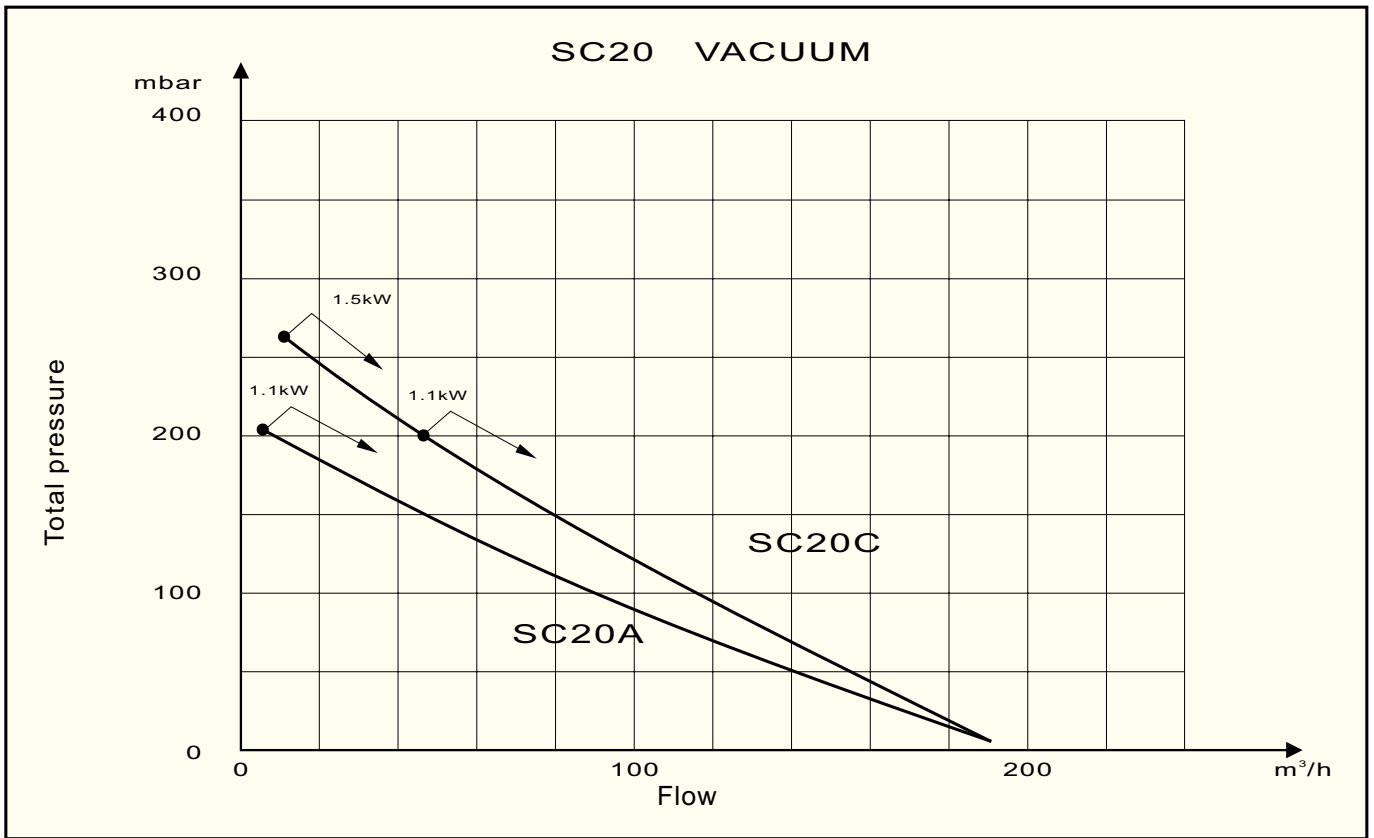

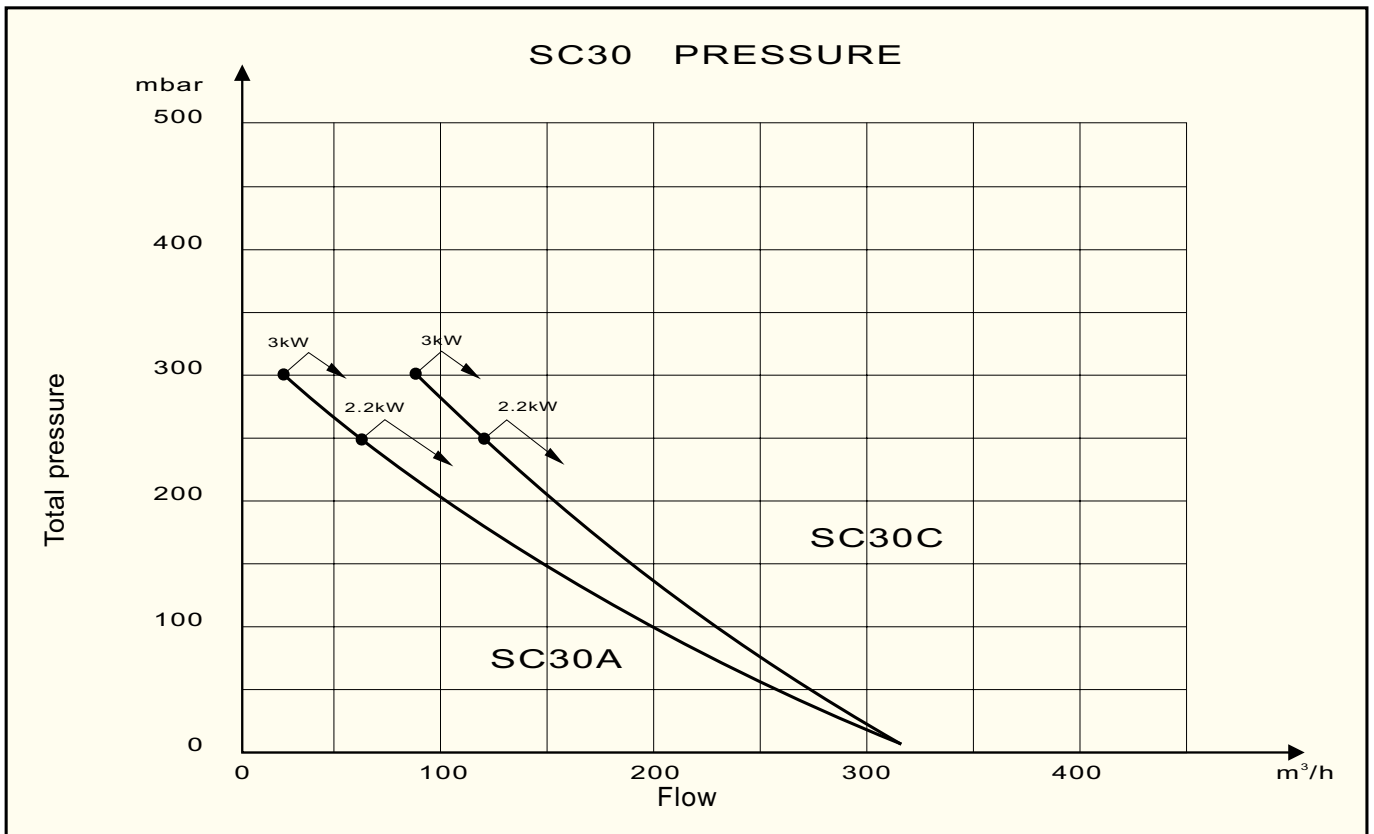
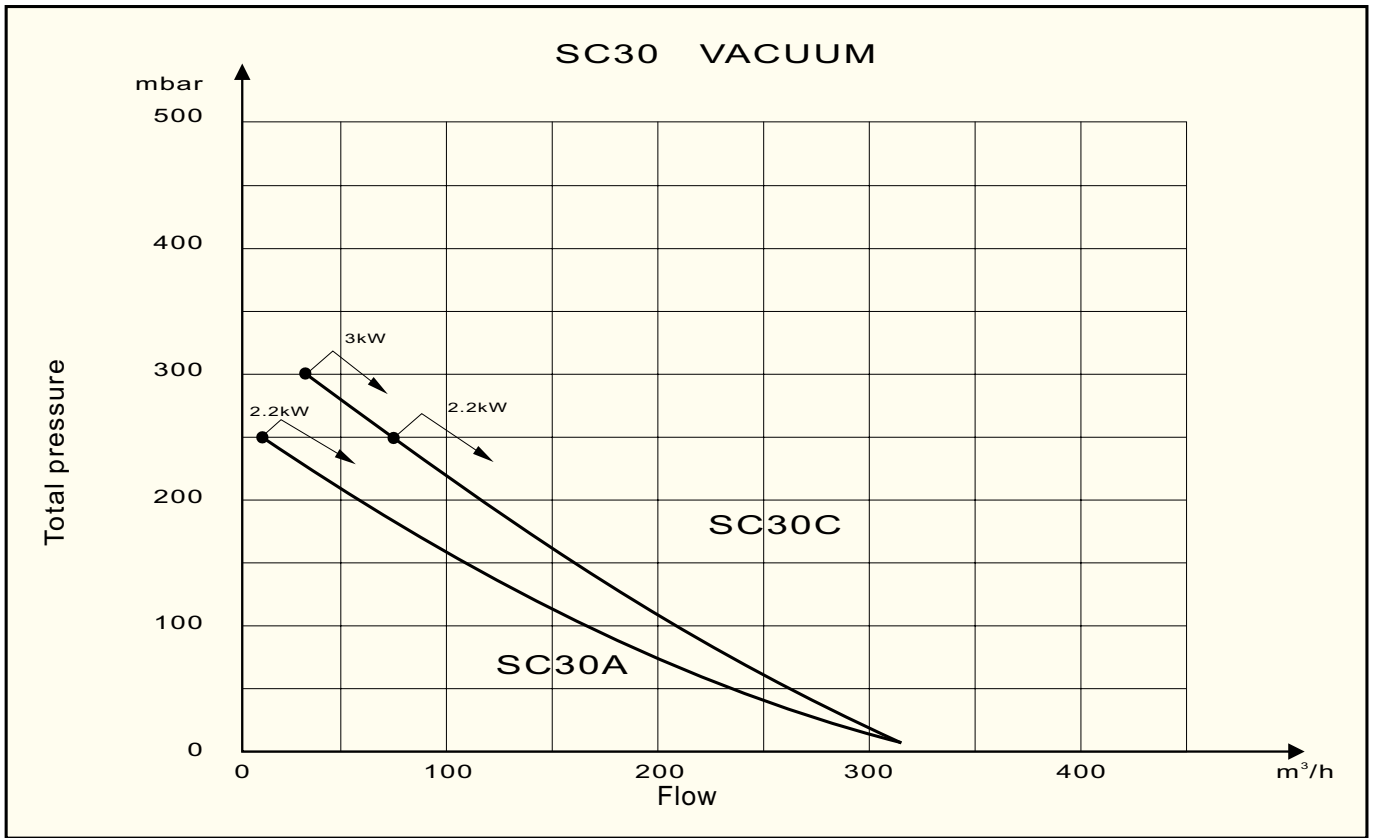

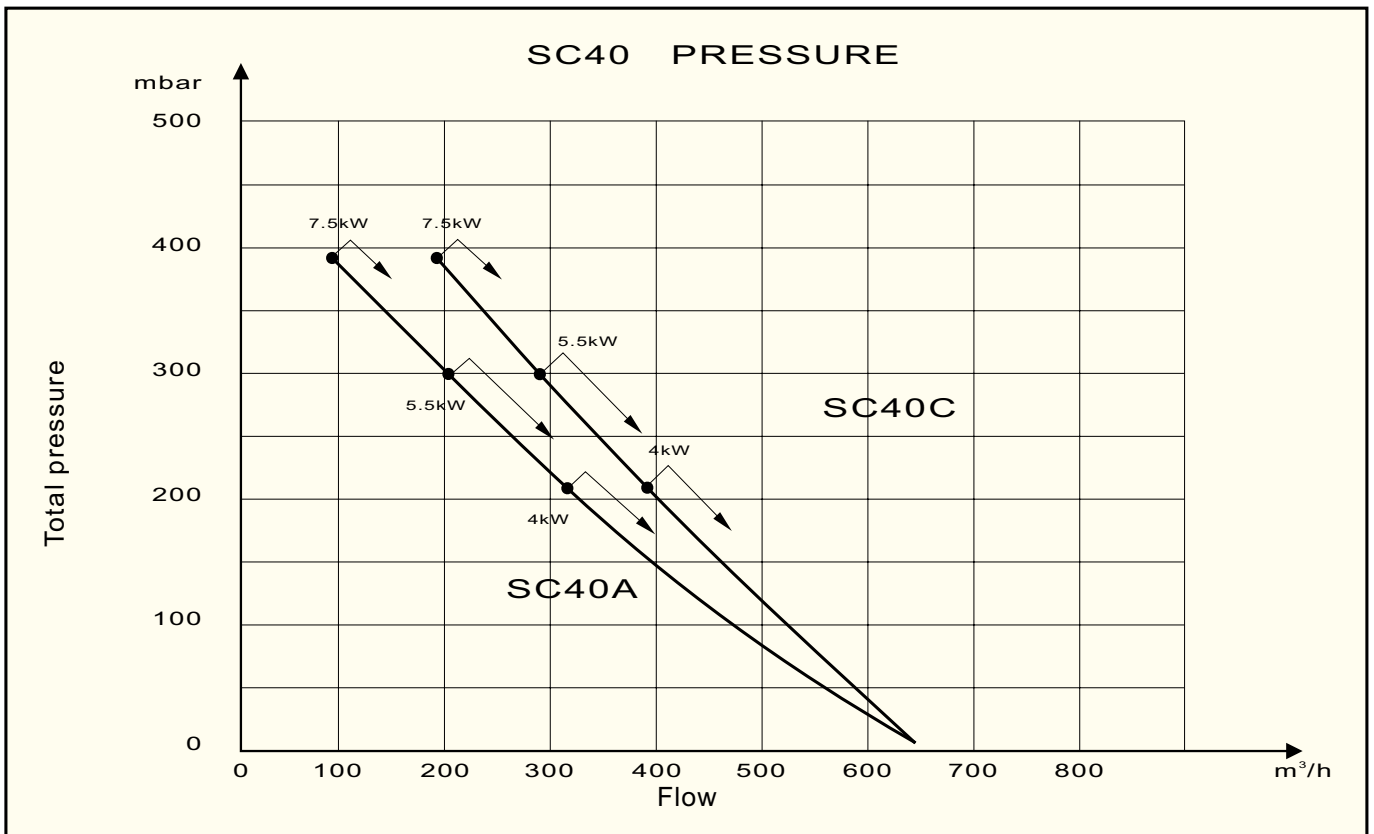
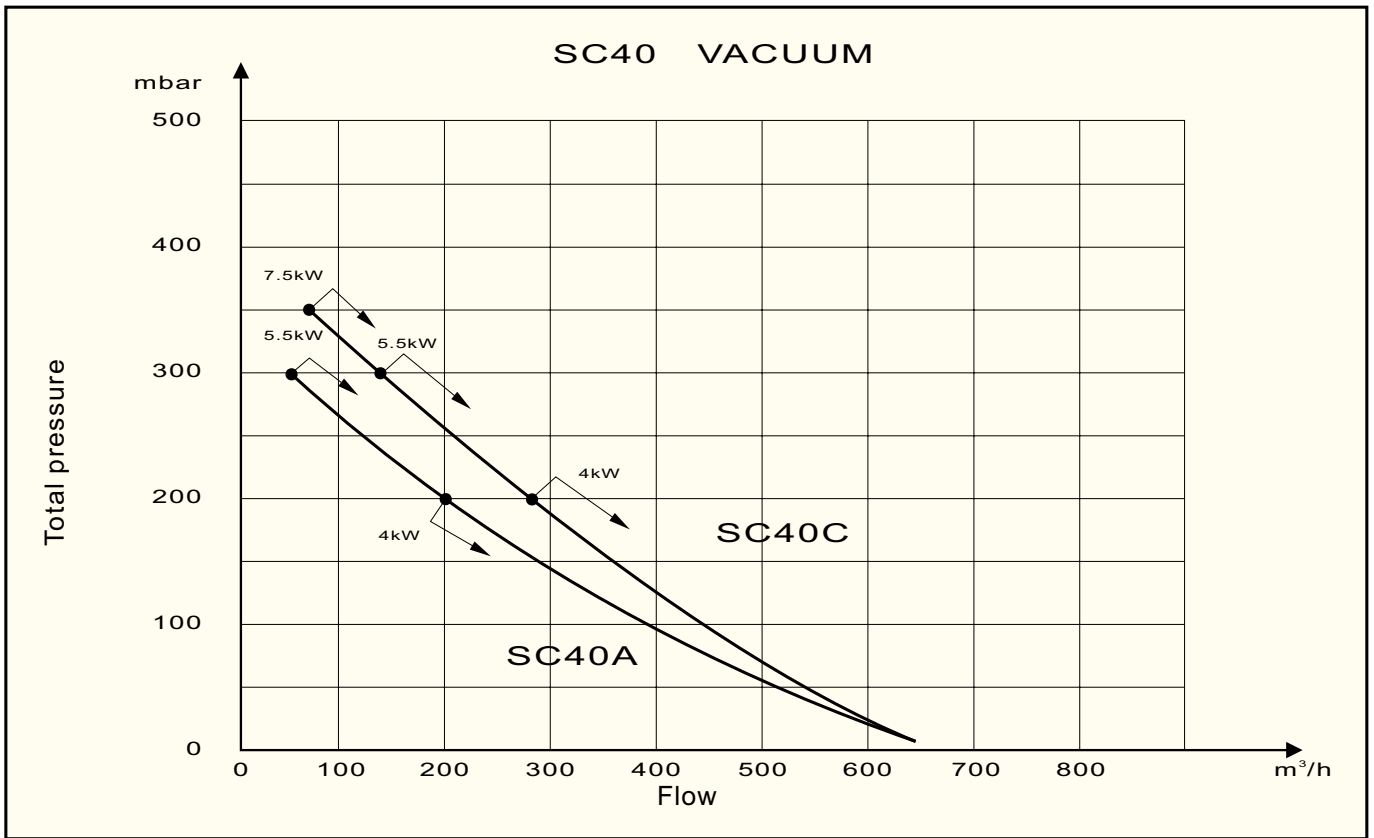

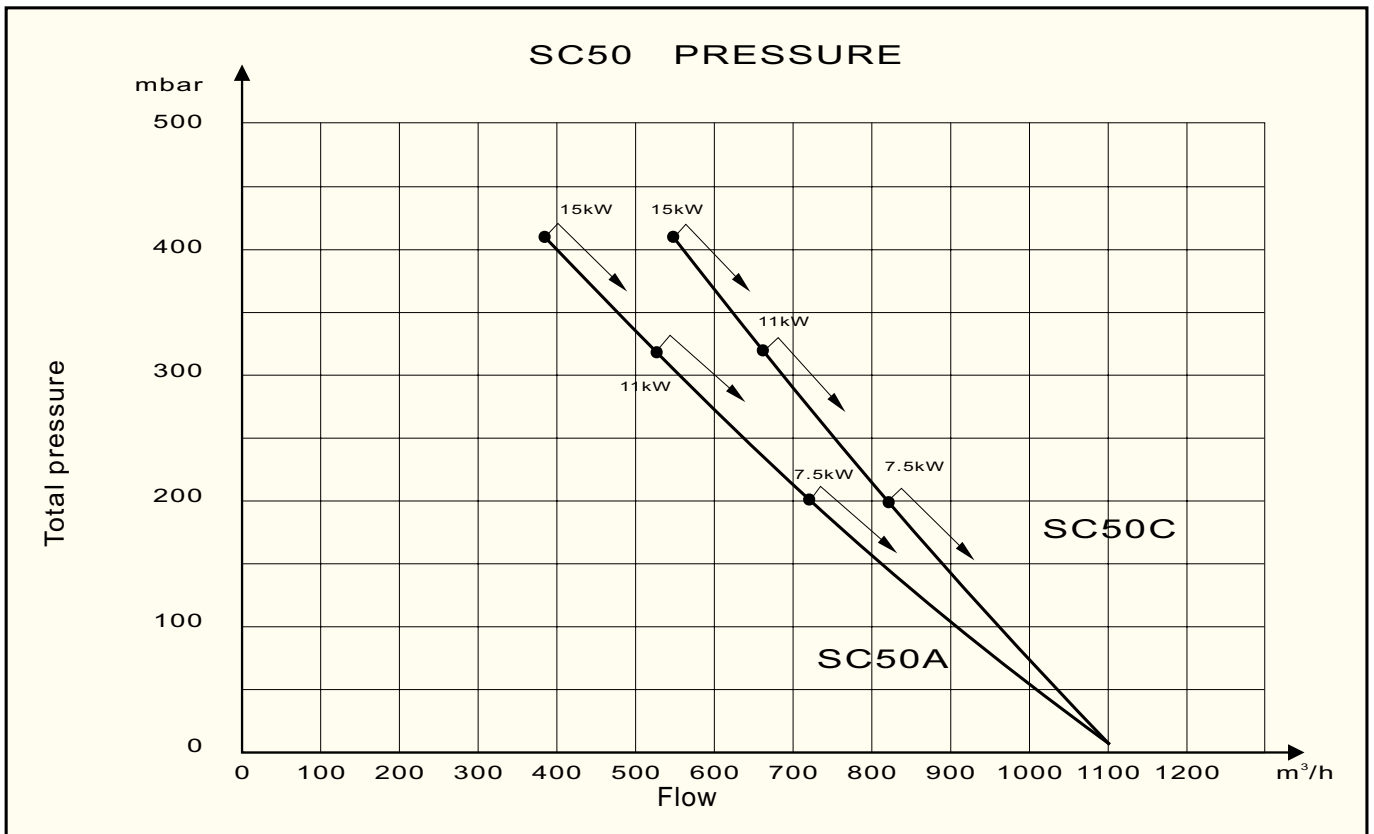
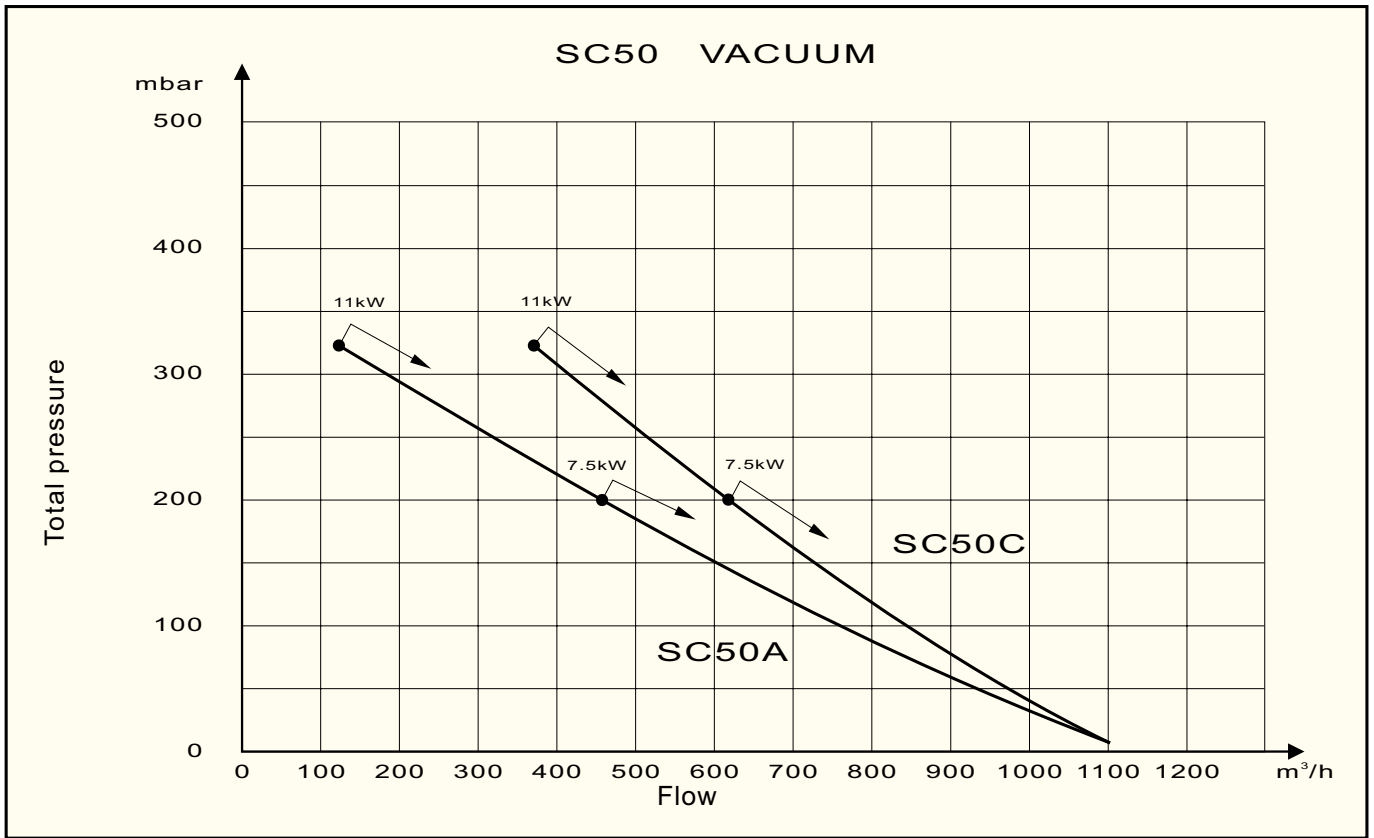

Side Channel Blower SC - V-belt drive

Technical specification

Type	Speed	Power consumption	Vacuum		Pressure		Weight*	Article number
	rpm		Flow max	Pressure max	Flow max	Pressure max		
		kW	m ³ /h	mbar	m ³ /h	mbar	kg	
SC15	4100	3.0	150	300	150	400	17	113 755 125
SC25	4100	4.2	250	400	250	500	21	113 755 185
SC35	4100	7.0	420	400	420	500	35	113 755 270
SC45	4100	14.5	850	400	850	500	64	113 755 330
SC55	4100	25.2	1500	400	1500	500	85	113 755 410

* bare unit

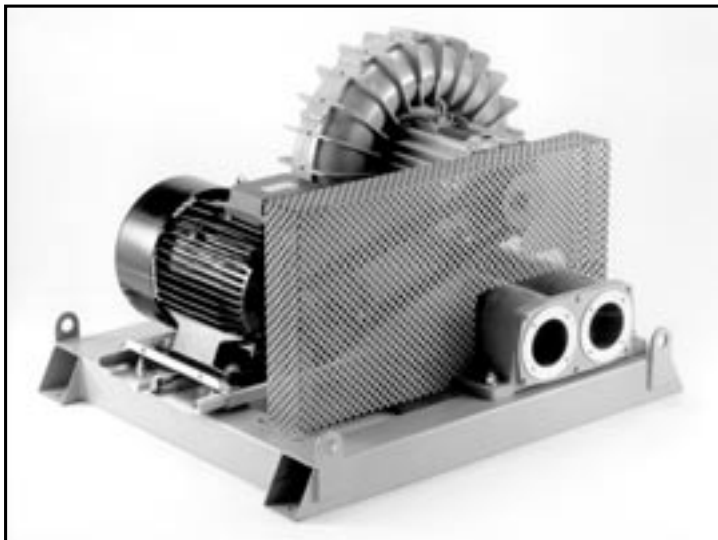

Type	A	B	C	D	E	F
SC15	700	450	330	70	660	410
SC25	700	450	390	70	660	410
SC35	760	530	483	140	700	490
SC45	995	800	612	180	935	740
SC55	1050	890	730	195	970	790

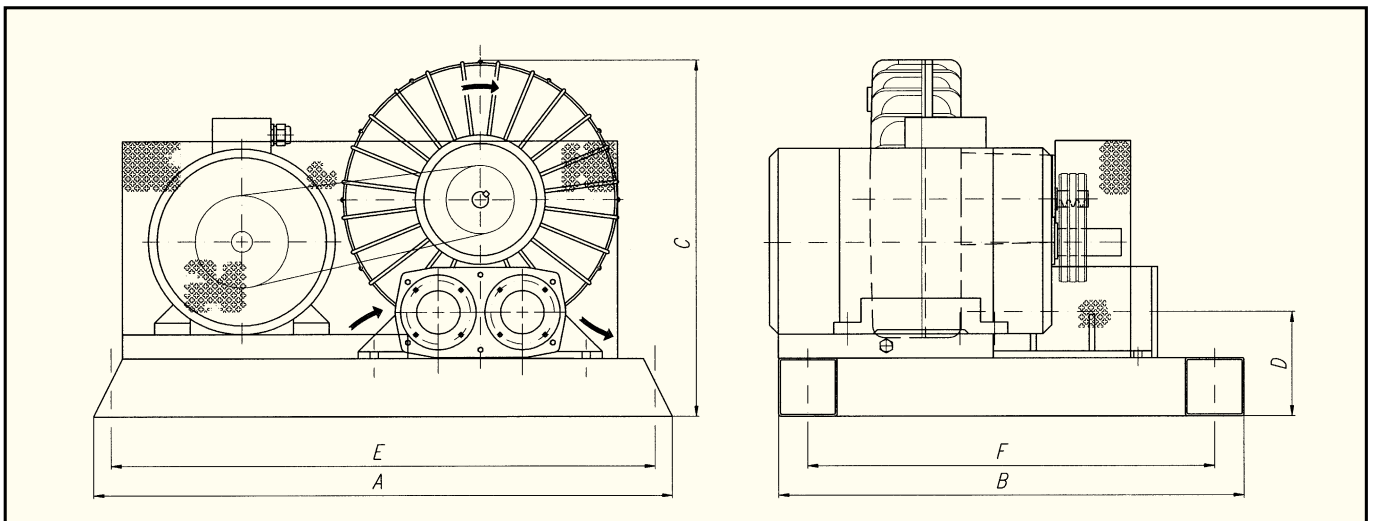

Performance curves

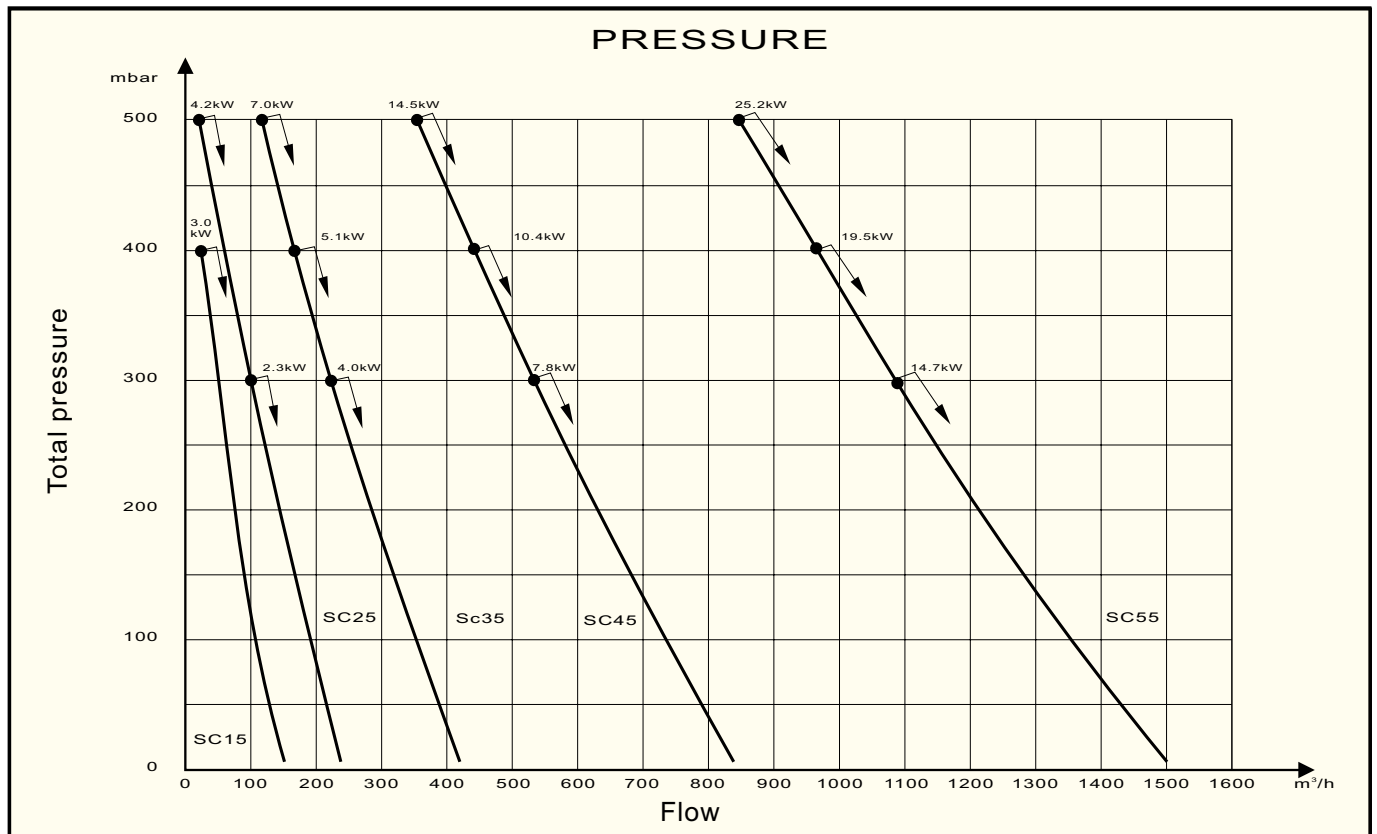
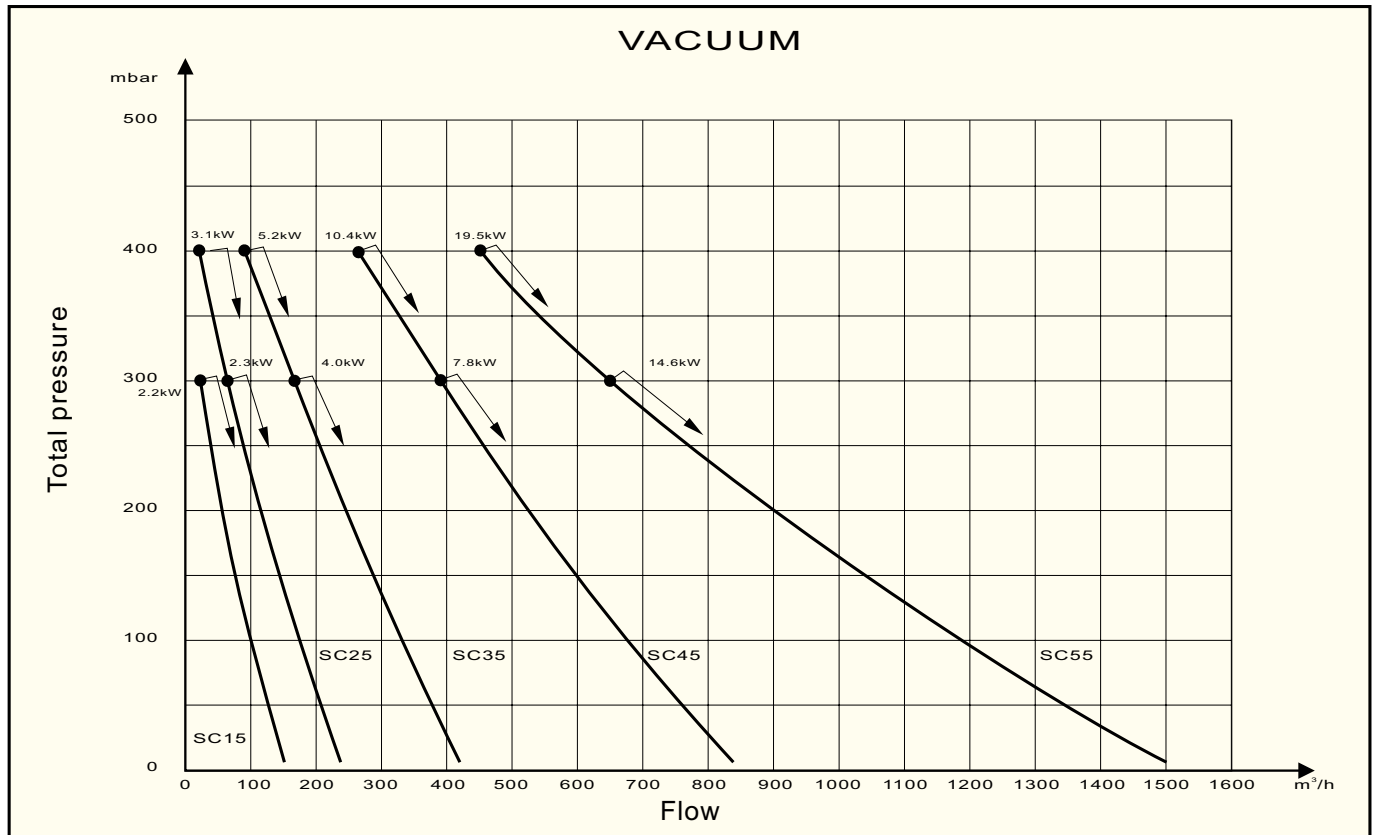

Side Channel Blower SC - Dimensions

Direct drive

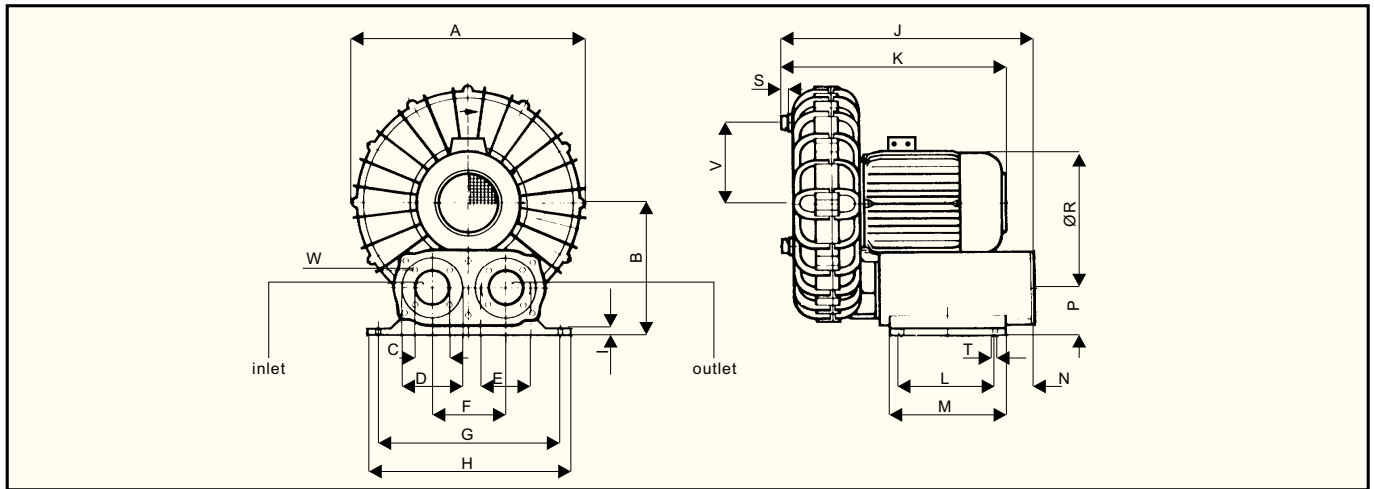

Type	A	B	C	D	E	F	G	H	I	J	K (max)	L	M	N	P	R	S	T	W	V
SC10	296	170	45	80	68	90	220	250	12	330	290	120	150	66	60	141	15	11	M5	117
SC20	360	200	45	80	68	90	220	250	12	360	348	120	150	66	60	157	15	11	M5	129.5
SC30	395	225	55	100	85	125	310	350	12	445	415	160	200	72	80	175	20	13	M6	140
SC40	480	275	75	130	110	145	365	420	12	530	510	260	300	34	80	230	30	14	M8	172
SC50	580	336	100	150	130	160	400	450	25	690	650	370	430	50	95	258	30	20	M8	202

Bare unit

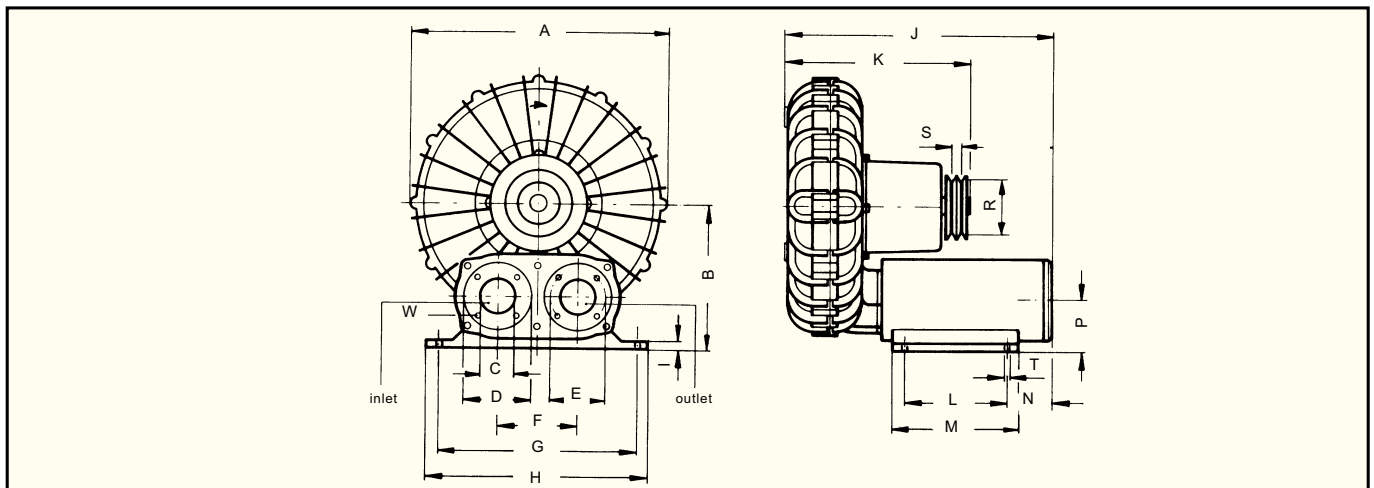

Type	A	B	C	D	E	F	G	H	I	J	K	L	M	N	P	R	S	T	W
SC15	296	170	45	80	68	90	220	250	12	315	215	120	150	66	60	75	12	11	M5
SC25	360	200	45	80	68	90	220	250	12	345	260	120	150	66	60	100	12	11	M5
SC35	395	225	55	100	85	125	310	350	12	425	300	160	200	72	80	100	12	13	M6
SC45	480	275	75	130	110	145	365	420	12	480	380	260	300	34	80	160	12	14	M8
SC55	580	336	100	150	130	160	400	450	20	620	490	370	430	58	95	160	12	20	M8



5 sizes, complete with lift handle, silencer, connectors, overload protection and 10m cable (single-phase with plug, three-phase with phase reversible Euro plug).

Special sizes can be supplied on request.

Application:

This unit can also be used for suction of water or insulation or other portable applications.

Technical specification

Type	Connection	Flow at 125 mbar pressure	Motor power	Voltage	Maximum current	Weight	Article number
	Ø mm	m ³ /h	kW	V	A	kg	
SCX10C-055S	51 (2,0")	55	0,55	230	4,0	24	113 750 161
SCX20A-110S	51 (2,0")	90	1,1	230	7,9	31	113 750 236
SCX20C-150S	51 (2,0")	120	1,5	230	8,7	33	113 750 241
SCX30A-220T	63 (2,5")	170	2,2	230/400	8,0/4,6	44	113 750 271
SCX30C-300T	63 (2,5")	210	3,0	230/400	11,3/6,5	48	113 750 286

Two Stage Fan 2SC

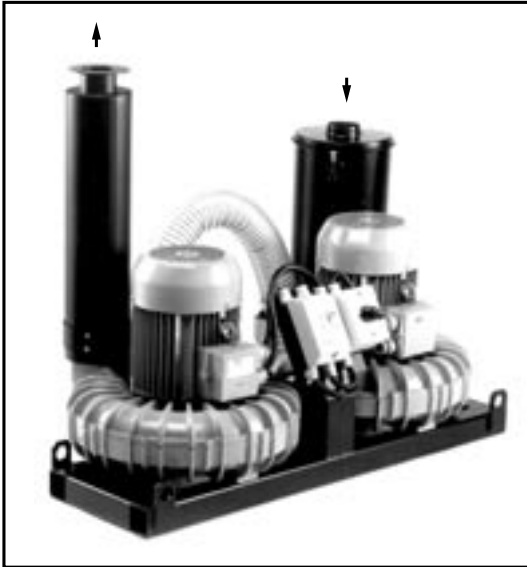

Combination of two in line side channel blowers complete with filter and silencer. All mounted on a common frame (see drawing).

Sizes 2SC10, 2SC20 and 2SC30 can be equipped with thermal protection and motor protection.

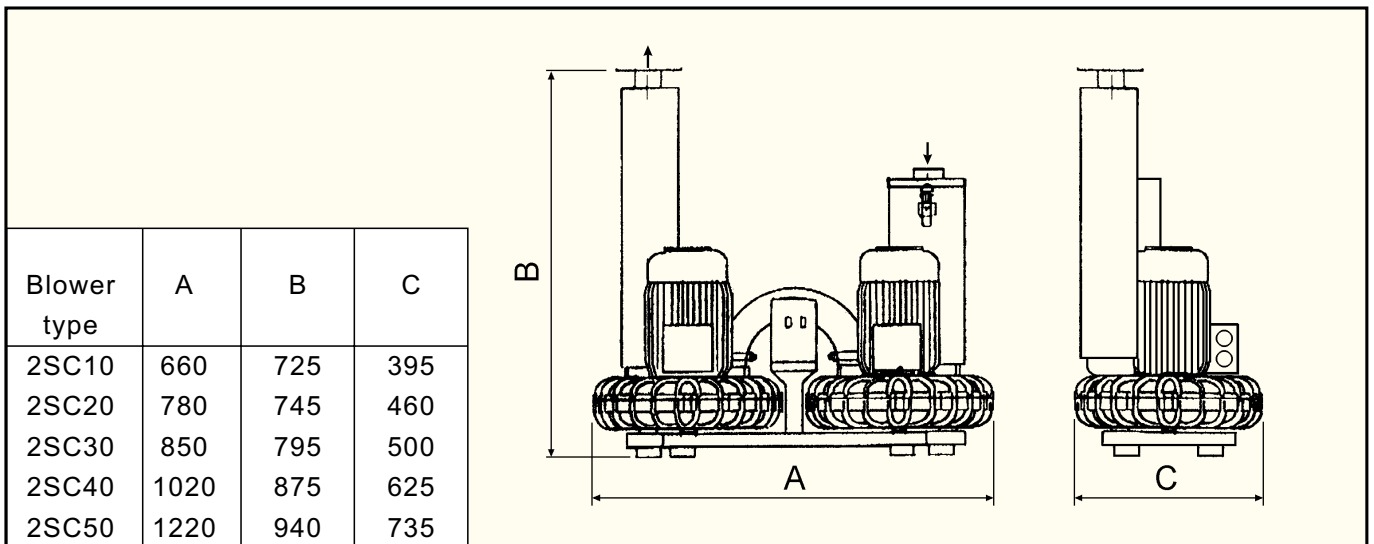

Technical specification

Type	Connection	Motor power	Voltage	Maximum current	Weight	Article number
	Ø mm	kW	V	A	kg	
2SC10C-130T	51 (2,0")	1,3	230/400	3,2 Y	50,0	113 750 136
2SC20C-260T	51 (2,0")	2,6	230/400	5,6 Y	60,0	113 750 424
2SC30C-520T	63 (2,5")	5,2	230/400	11,2 Y	85,0	113 750 287
2SC40C-950T	76 (3,0")	9,5	400/690	19,1 Δ	160,0	113 750 353
2SC40C-1300T	76 (3,0")	13,0	400/690	25,1 Δ	165,0	113 750 354
2SC50C-1850T	100 (4,0")	18,5	400/690	35,0 Δ	300,0	113 750 461
2SC50C-2600T	100 (4,0")	26,0	400/690	49,2 Δ	330,0	113 750 462

Other sizes can be supplied on request.

Two Stage Fan 2SC

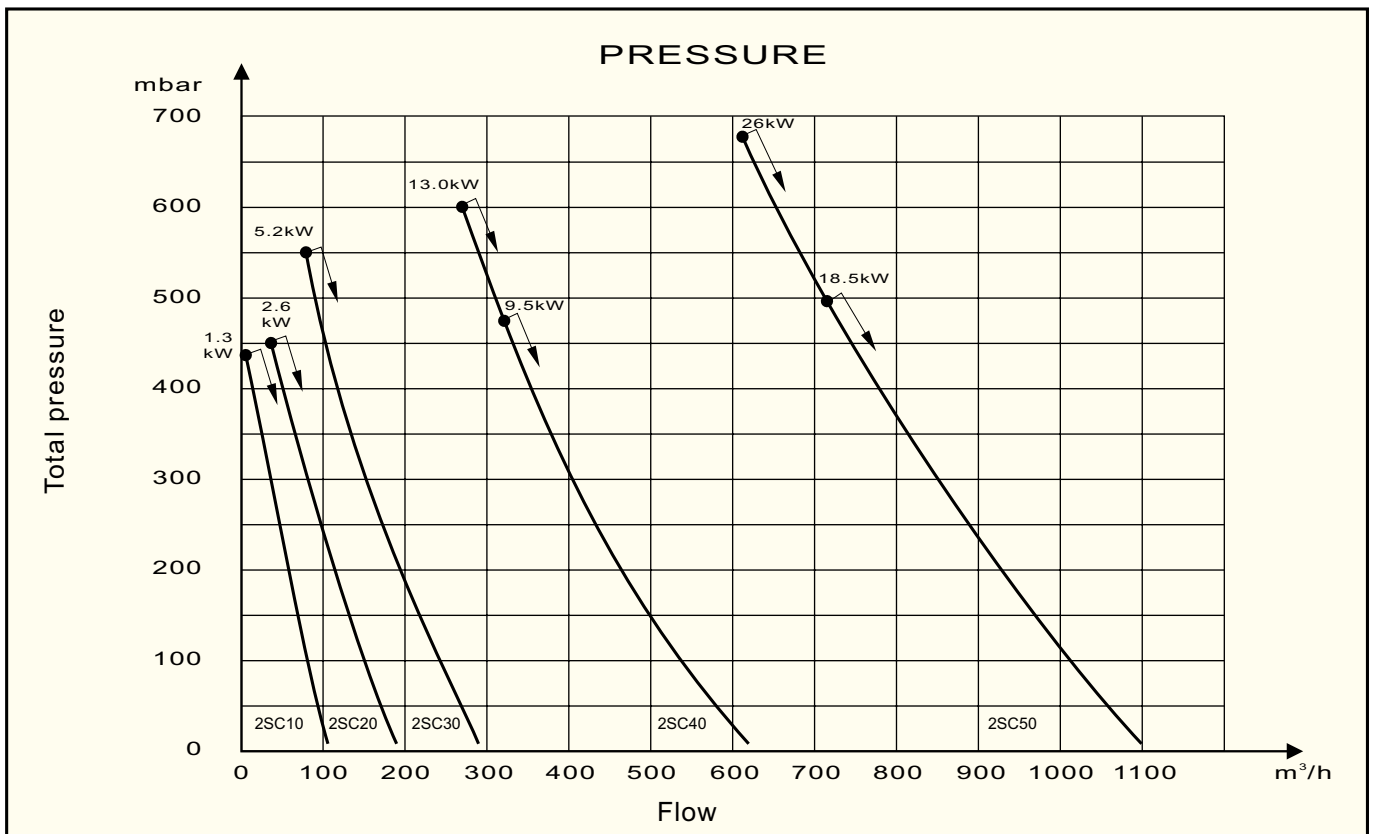
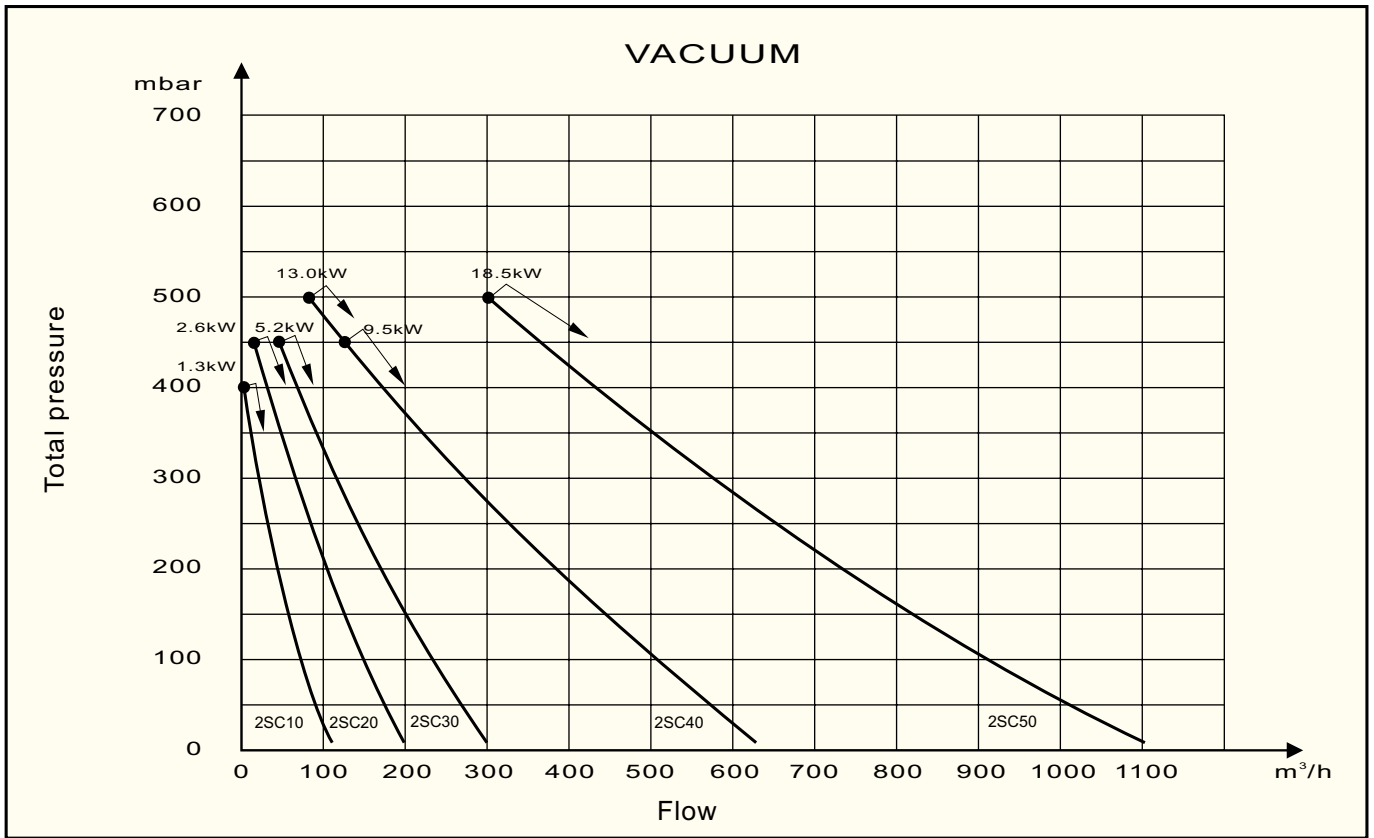

Connector

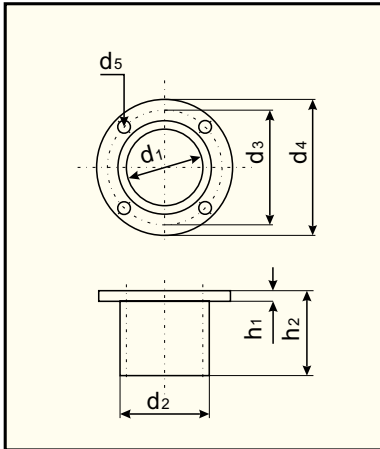

Type	d1	D2	d3	d4	d5	h1	h2	Article Number
SC10	46	51	68	80	6.0	6	60	113 761 185
SC20	46	51	68	80	6.0	6	60	113 761 185
SC30	57	63	85	100	7.0	8	60	113 761 270
SC40	70	76	110	130	9.0	10	60	113 761 330
SC50	96	102	130	145	9.0	12	60	113 761 411

Welding flange

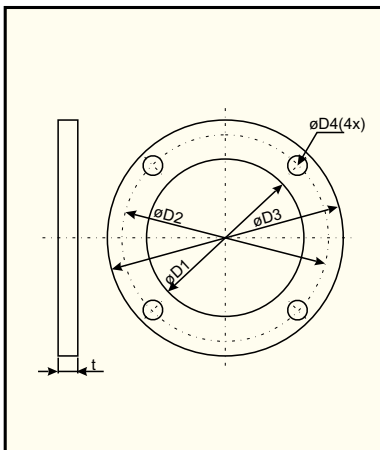

Type	D1	D2	D3	D4	t	Article Number
SC10	45	68	80	5.5	10	113 762 185
SC20	45	68	80	5.5	10	113 762 185
SC30	58	85	104	6.5	10	113 762 270
SC40	75	110	130	9.0	10	113 762 330
SC50	100	130	150	9.0	10	113 762 411

Threaded flange

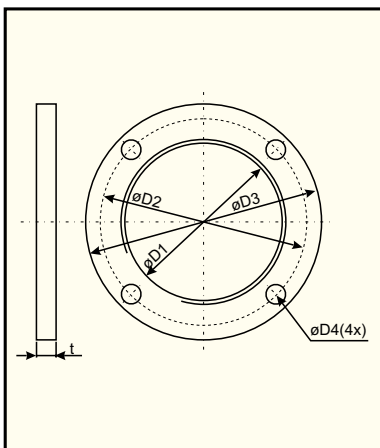

Type	D1	D2	D3	D4	t	Article number
SC10	R1½" x 15	68	80	5.5	15	113 763 185
SC20	R1½" x 15	68	80	5.5	15	113 763 185
SC30	R2" x 15	85	104	6.5	15	113 763 270
SC40	R2½" x 20	110	130	9.0	20	113 763 330
SC50	R3½" x 20	130	150	9.0	20	113 763 411

Silencer with connector

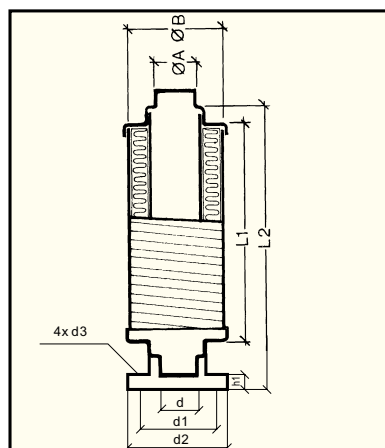

Type	A	B	d	d1	d2	d3	h1	l1	l2	Article Number
SC10	50	105	45	68	80	6,0	6	455	610	113 767 185
SC20	50	105	45	68	80	6,0	6	455	610	113 767 185
SC30	70	125	60	85	100	7,0	8	455	620	113 767 270
SC40	80	125	75	110	130	9,0	10	455	630	113 767 330
SC50	100	150	95	130	145	9,0	12	455	640	113 767 411

Filter

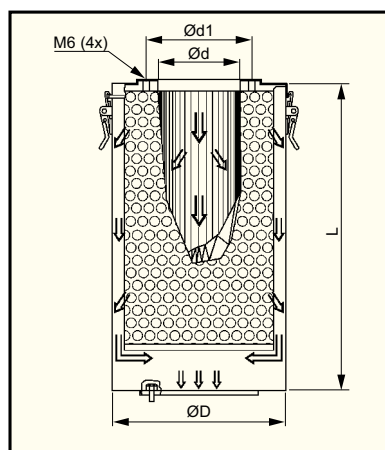

Blower type	Filter type	Article number	Cartridge type	Article number	ØD	Ød	L	Ød1
SC10,SC20	G20	113 770 125	PG 20	113 771 125	156	51	374	68
	F20	113 770 126	PF 20	113 771 126				
SC30	G30	113 770 270	PG 30	113 771 125	156	63	374	68
	F30	113 770 271	PF 30	113 771 126				
SC40	G40	113 770 330	PG 40	113 771 330	219	76	394	110
	F40	113 770 331	PF 40	113 771 331				
SC50	G50	113 770 411	PG 50	113 771 330	219	101	394	130
	F50	113 770 412	PF 50	113 771 331				

G - standard filter, F - fine filter DOP 99,97%

Pressure and vacuum relief valve

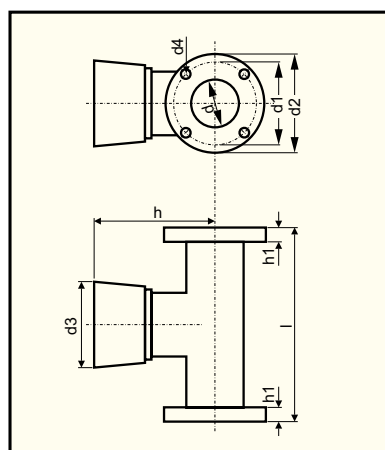

Blower type	L	d	d1	d2	d3	d4	h	h1	Vakuum Article number	Pressure Article number
SC10	180	45	68	80	125	6	150	8	113 768 401	113 768 451
SC20	180	45	68	80	125	6	150	8	113 768 403	113 768 453
SC30	180	55	85	100	125	7	150	8	113 768 406	113 768 456
SC40	206	75	110	130	180	9	210	8	113 768 411	113 768 461
SC50	206	100	130	145	180	9	210	8	113 768 415	113 768 465

Thermal protection

To protect the blower against overheating, a thermal protection (TP) device can be located at the bearing as indicated below. When the critical temperature of the ball bearing is reached, the thermal protection switch interrupts the supply through the contactor coil and disconnects the blower. Other functions could also be connected through the thermal protection switch, such as valves, alarms, etc.

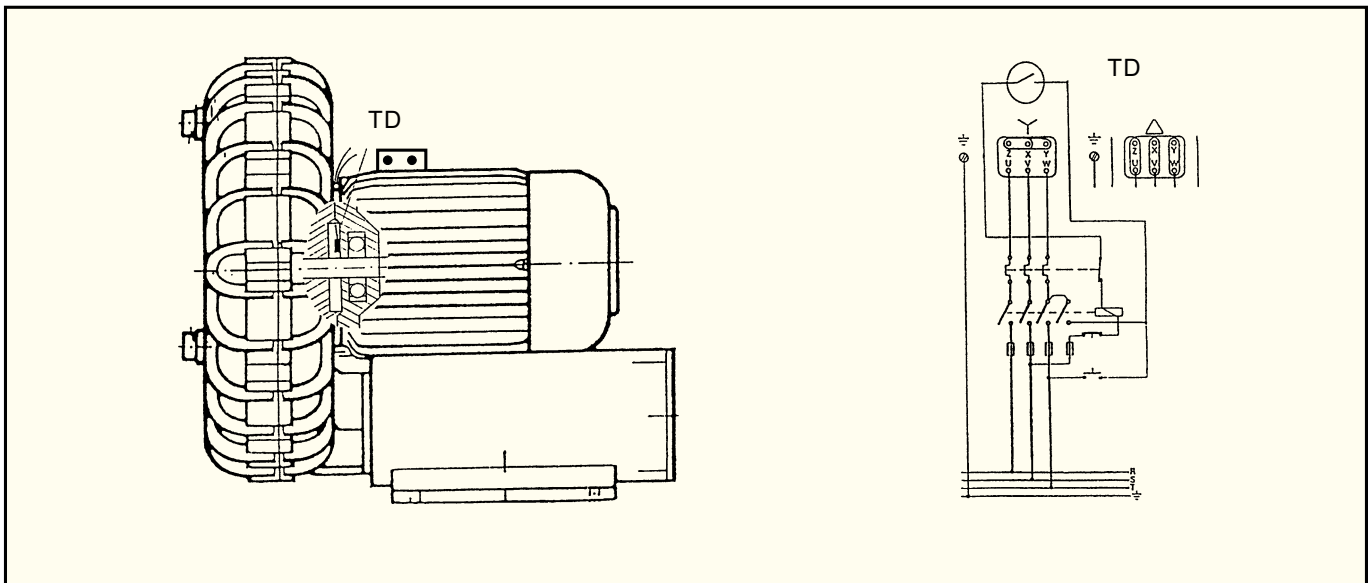

Automatic reversing valve

Motor driven reversing valve in cast aluminium mounted directly on the side channel blower. The reversing valve allows reversing from pressure to vacuum in the shortest possible time without having to change the direction of rotation of the blower.

Automatic reversing valve can be supplied on request.

